



COMMERCIAL REFRIGERATION EQUIPMENT FOR THE PROFESSIONAL

www.fosterrefrigeration.com  
Toll free: 1.833.367.8373

Model #:  
**FBB-4G-HC**

Backbar Series:  
**Triple Swing Glass Door Back Bar Cooler - Hydrocarbon Refrigerant**



## FBB-4G-HC

- **Cabinet Construction**  
Painted steel exterior and stainless steel interior including floor.
- **Rounded corner** design inside of cabinet for easy cleaning.
- **Standard door features:**  
Heavy duty pull handle. Each door features two spring loaded hinges with automatic closing.  
90° Hold-open feature for easy loading and unloading.
- **Refrigeration system** holds 33°F to 41°F (0.5°C to 5°C).
- **CAREL Electronic Control System**  
Fully adjustable temperature set points and defrost frequency. Self monitors to diagnose service status. Carel is a world leader in refrigeration controls.
- **Shelf:** Adjustable, heavy duty PVC coated shelves.
- **Lock & key:** protect contents.  
Easily accessible condenser coil for cleaning.
- **L.E.D. Lighting** inside cabinet.



*Rough-In Data*



\*Specifications subject to change without notice.

Specifications subject to change without notice.

Model	Doors	Cabinet Dimensions (inches) (mm)			Shelves	Capacity		HP	Voltage	Amps	NEMA Config.	Crated Weight (pounds) (kg)
		L	D	H		12 oz. Cans	1/2 Barrels					
FBB-4-HC	3	90 3/8 2295	27 3/4 705	36 1/4 920	6	152 packs	4	1/4	115/60/1	4	5-15P Ⓜ	427 194



# STANDARD FEATURES

## Hydrocarbon Refrigeration System

- Foster's innovative and environmentally friendly design incorporates R-290 hydrocarbon refrigerant. Hydrocarbon refrigerants are naturally occurring and have zero ozone depletion potential (ODP-0) and a global warming potential of three (GWP-3).
- Factory balanced, self contained refrigeration system maintains temperatures of 33°F to 40°F (0.5°C to 5°C).

## Digital temperature control and monitoring system

- Digital temperature control and monitoring is powered by Carel. Carel is a world leader in refrigeration system controls.
- Automatic evaporator fan motor delays.
- Digital display for real time monitoring.
- Auto-defrost function.

## Doors

- Painted steel exterior with stainless steel liner.
- Positive self closing/sealing with removable gasket for cleaning or replacement.
- Stay open feature allows door to remain open at 100° for easy loading or unloading.

## Cabinet Construction

- Foster Bar Coolers feature durable painted steel exterior body. The interior cabinet is full stainless steel construction with radius cornered floor pan for easy cleaning.
- Foamed in place CFC and HCFC free polyurethane insulation enhances the structural strength of the cabinet and increases energy efficiency.
- Cabinet insulation - cabinet is constructed with a foamed in place process using a high density, polyurethane insulation. This insulation has zero ozone depletion potential (ODP) and zero global warming potential (GWP).

## Shelving

- Six adjustable PVC coated shelves are included.



## PLAN VIEW

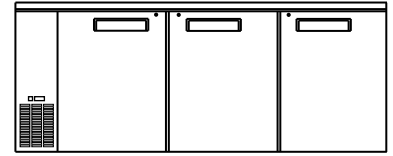

## FRONT VIEW

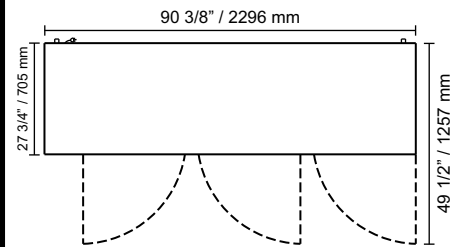

## PLAN VIEW

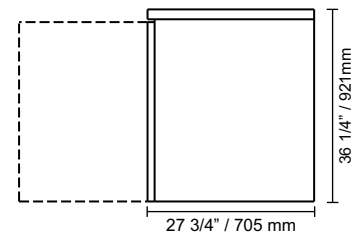

## SIDE VIEW